

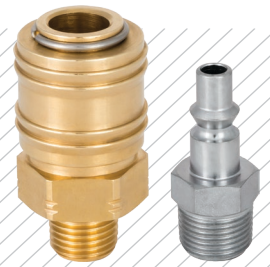

PNEUMATIC COUPLINGS
PNEUMATISCHE KUPPLUNGEN

SERIE 014

DN 5.5



Materials

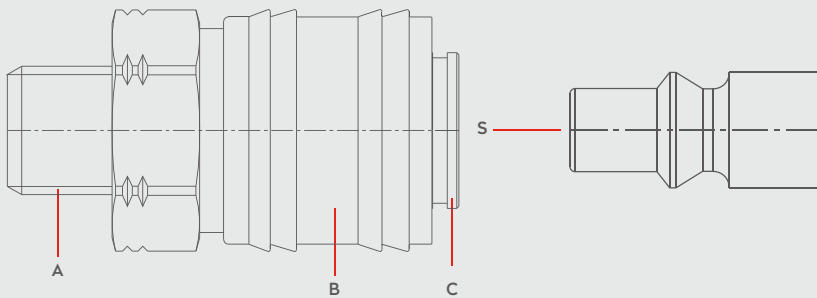

Material Code

- A = Brass
- B = Brass
- C = Brass
- S = Steel Zinc Plated



0 - 35 bar
(0-508 PSI)



-20° to + 100°C (NBR)
-4° to + 212°F

Shut Off Type



OM 240 - 00530
OM 250 - 00750

FLOW 560 lt/min

DN 5.5 mm

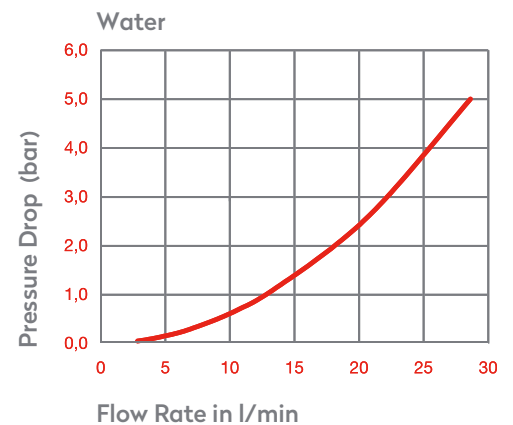
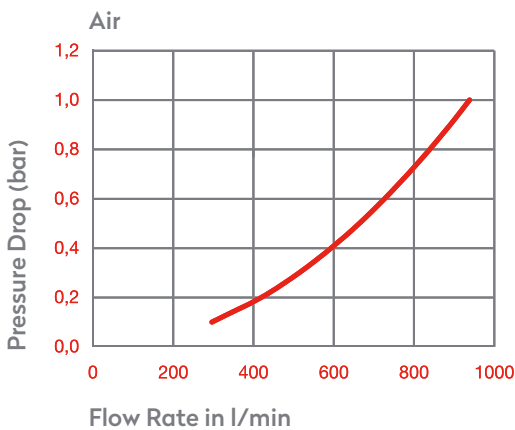

Options

NICKEL
Steel
SWING
2 STAGE
2 STAGE

A1 Serie
022S
022S.06

Plug Profile Serie 014

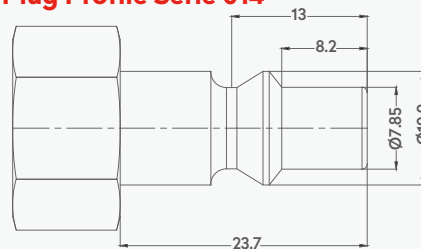

Compatible with

TST SWING COUPLING	A1
AMFLO	C38
ARO	210
CEJN	300
FOSTER	210
PARKER	B53
PARKER - RECTUS	14, 22



ARO 210

QUICK COUPLINGS SCHNELLKUPPLUNGEN

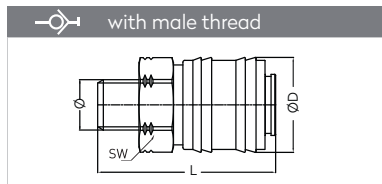

Connection	Part No.	SW	L	ØD
BSPT 1/4"	014 RG 13	22	46,5	24,8
BSPT 3/8"	014 RG 17	22	46,5	24,8
BSPT 1/2"	014 RG 21	22	51,5	24,8

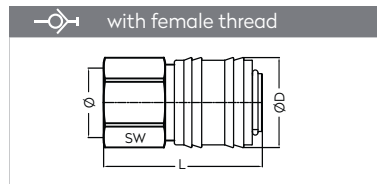

Connection	Part No.	SW	L	ØD
BSP 1/4"	014 DG 13	22	44,5	24,8
BSP 3/8"	014 DG 17	22	44,5	24,8
BSP 1/2"	014 DG 21	23	47,5	24,8

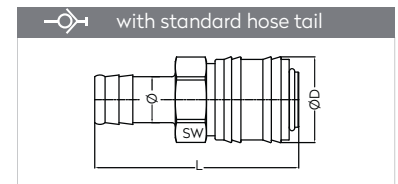

Connection	Part No.	SW	L	ØD
6 mm - 1/4"	014 HG 06	22	59	24,8
8 mm - 5/16"	014 HG 08	22	59	24,8
9 mm - 5/14"	014 HG 09	22	59	24,8
10 mm - 3/8"	014 HG 10	22	59	24,8
13 mm - 1/2"	014 HG 13	22	59	24,8

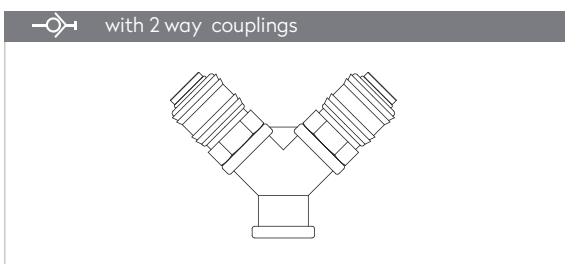

Connection	Part No.
BSP 1/4"	014 2G 13
BSP 3/8"	014 2G 17

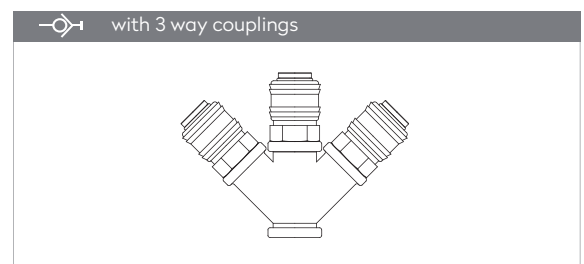

Connection	Part No.
BSP 3/8"	014 3G 17

PLUGS STECKNIPPEL

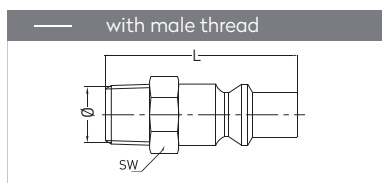

Connection	Part No.	SW	L
BSPT 1/8"	014 RU 10	12	40
BSPT 1/4"	014 RU 13	14	43
BSPT 3/8"	014 RU 17	17	43
BSPT 1/2"	014 RU 21	22	48
NPT 1/8"	014 TU 10	12	38
NPT 1/4"	014 TU 13	14	43
NPT 3/8"	014 TU 17	17	40
NPT 1/2"	014 TU 21	22	43

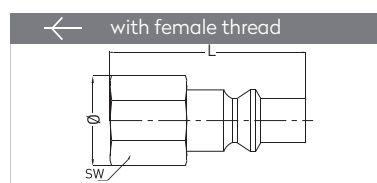

Connection	Part No.	SW	L
BSP 1/8"	014 DU 10	14	34
BSP 1/4"	014 DU 13	17	37
BSP 3/8"	014 DU 17	19	37
BSP 1/2"	014 DU 21	24	41

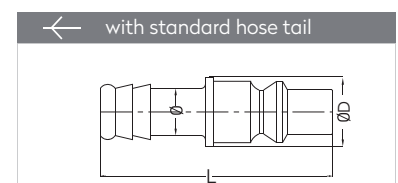

Connection	Part No.	L	ØD
6 mm - 1/4"	014 HU 06	48	12
8 mm - 5/16"	014 HU 08	48	12
9 mm - 5/14"	014 HU 09	48	12
10 mm - 3/8"	014 HU 10	48	12
13 mm - 1/2"	014 HU 13	48	15